

FlexGro®

Rocker Style Biocontainer Assemblies

Standards Guide
One-Touch® Single-Use Systems



Table of Contents

FlexGro® Rocker Style Biocontainer Assemblies	3
Biocontainer Volumes	3
Standard Port Options	4
Basic Option	4
Expanded Basic Option	4
Standard Option	4
10 L FlexGro® Biocontainer Assemblies	5
Basic Option	5
Expanded Basic Option	6
Standard Option	7
20 L FlexGro® Biocontainer Assemblies	8
Basic Option	8
Expanded Basic Option	9
Standard Option	10
22 L FlexGro® Biocontainer Assemblies	11
Basic Option	11
Expanded Basic Option	12
Standard Option	13
50 L FlexGro® Biocontainer Assemblies	14
Basic Option	14
Expanded Basic Option	15
Standard Option	16

FlexGro® Biocontainer Assemblies

FlexGro® rocker style biocontainer assemblies are ideal for various cell culture applications and can be ordered from our standards portfolio in 10, 20, 22 and 50 liter nominally rated volumes that accommodate working volumes up to 25 liters. FlexGro® assemblies can be deployed on common rocking hardware.

FlexGro® biocontainers are manufactured from Meissner's ultraclean TepoFlex® polyethylene (PE) based multi-layer film. TepoFlex® PE film delivers an exceedingly low extractables profile and is devoid of slip agents, providing robust and repeatable performance for your cell culture process. It is the ideal choice for cell cultivation in process development, small scale production and seed train applications.

FlexGro® biocontainer assemblies can be easily customized to include specific sampling and process connections, as well as tubing and port options, to cater to your process. Meissner also offers complementary products, such as FlexFill® assemblies which cater to applications that require aseptic fluid transfer from a bottle to a single-use system, and multi-stage filtration assemblies that are optimized for harvest applications. More information can be found at www.meissner.com/flexfill. Our applications engineering team can assist in both the customization of a FlexGro® biocontainer assembly for your specific needs, as well as an overall optimization of your process from inoculation to harvest.



Biocontainer Volumes

Nominal Biocontainer Volume	Working Volume*	GE Healthcare	Sartorius Stedim Biotech
10 L	0.5 L - 5 L	System 2/10, System 20/50 with Kit 20	RM 20/50 with Holder 20
20 L	1 L - 10 L	System 20/50 with Kit 20	RM 20/50 with Holder 20
22 L	1 L - 10 L	System 20/50 with Kit 50	N/A
50 L	5 L - 25 L	System 20/50 with Kit 50	N/A

*Working volume is a maximum 50% of nominal biocontainer volume.





FlexGro® Biocontainer Assemblies

1 Basic Option

Meissner's Basic Option for the FlexGro® biocontainer assembly includes 4 ports: a gas inlet filter, an outlet vent filter with a check valve, a needleless sampling or inoculation port and a weldable line with an MPC fitting, which is often used for media feed or harvest applications.

Port 1	Port 2	Port 3	Port 4
Inlet Air Filter	Outlet Air Filter, Check Valve	2" Silicone Tubing (5.1 cm Silicone Tubing), Needleless Sampling Valve	40" Length (101.6 cm Length), 1/4" x 7/16" TPE Tubing (6.4 mm x 11.1 mm TPE Tubing), Female QDC + Plug

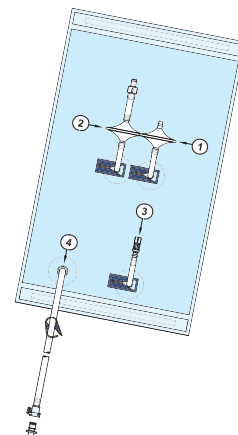

2 Expanded Basic Option

Meissner's Expanded Basic Option for the FlexGro® biocontainer assembly includes 5 ports: a gas inlet filter, an outlet vent filter with a check valve, a needleless sampling or inoculation port, a weldable line with an MPC fitting, which is often used for media feed or harvest applications, and an additional smaller bore weldable line with luer connectivity via a female luer fitting.

Port 1	Port 2	Port 3	Port 4	Port 5
Inlet Air Filter	Outlet Air Filter, Check Valve	2" Silicone Tubing (5.1 cm Silicone Tubing), Needleless Sampling Valve	40" Length (101.6 cm Length), 1/4" x 7/16" TPE Tubing (6.4 mm x 11.1 mm TPE Tubing), Female QDC + Plug	40" Length (101.6 cm Length), 1/8" x 1/4" TPE Tubing (3.2 mm x 6.4 mm TPE Tubing), Female Luer + Plug

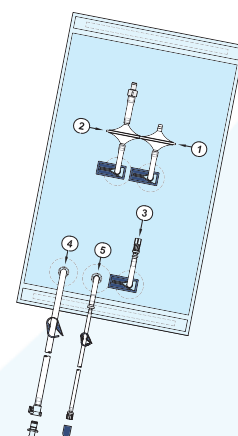

3 Standard Option

Meissner's Standard Option for the FlexGro® biocontainer assembly includes 6 ports: a gas inlet filter, an outlet vent filter with a check valve, a needleless sampling or inoculation port, a weldable line with an MPC fitting, which is often used for media feed or harvest applications, and two additional lines with luer connectivity via a female luer fitting – one is a smaller bore weldable line and the other provides minimal hold up volume.

Port 1	Port 2	Port 3	Port 4	Port 5	Port 6
Inlet Air Filter	Outlet Air Filter, Check Valve	2" Silicone Tubing (5.1 cm Silicone Tubing), Needleless Sampling Valve	40" Length (101.6 cm Length), 1/4" x 7/16" TPE Tubing (6.4 mm x 11.1 mm TPE Tubing), Female QDC + Plug	40" Length (101.6 cm Length), 1/8" x 1/4" TPE Tubing (3.2 mm x 6.4 mm TPE Tubing), Female Luer + Plug	2" Silicone Tubing (5.1 cm Silicone Tubing), Female Luer + Plug

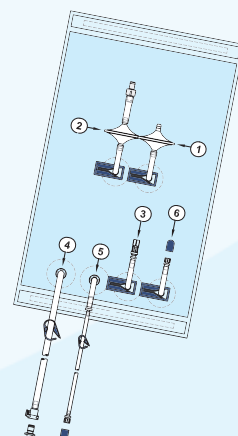

10
Liter

Basic Assembly Option

Bill of Materials

Item	Description	Material	Qty
1	10 L FlexGro® Biocontainer	TepoFlex®	1
2	High Flow Check Valve, 3/8" Hose Barb (High Flow Check Valve, 9.5 mm Hose Barb)	Acrylic/Silicone	1
3	3/16" x 3/8" Tubing, 2" Length (4.8 mm x 9.5 mm Tubing, 5.1 cm Length)	Platinum-Cured Silicone	4
4	High Flow Vent Filter	Acrylic/Pallflex	2
5	Slide Clamp, Medium	HDPE	3
6	Male Luer Cap	Polycarbonate	1
7	Swabable Valve / Needleless Injection Site	Polycarbonate/ Silicone	1
8	1/4" Hose Barb x Female Luer Adapter (6.4 mm Hose Barb x Female Luer Adapter)	Polypropylene	1
9	Ratchet Pinch Clamp, Medium	Polypropylene	1
10	1/4" x 7/16" Tubing, 40" Length (6.4 mm x 11.1 mm Tubing, 101.6 cm Length)	374 C-Flex	1
11	Coupling Body, 1/4" Hose Barb, MPC (Coupling Body, 6.4 mm Hose Barb, MPC)	Polycarbonate	1
12	Sealing Plug, MPC	Polycarbonate	1

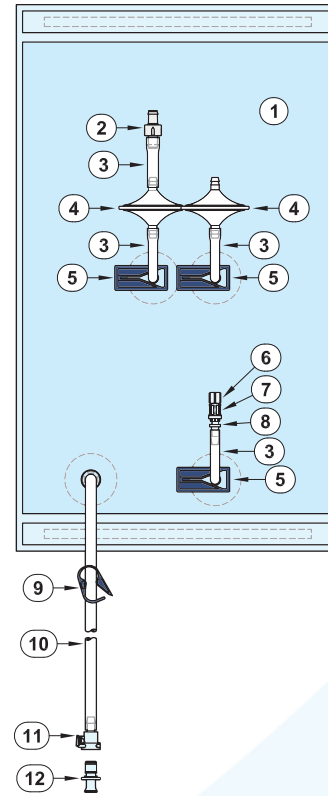

Assembly Part Number	Description	Min Operating Volume	Max Operating Volume
DRA4305B-N01-B0254-01	10 L Basic FlexGro® Assembly	0.5 L	5 L



Expanded Basic Assembly Option

Bill of Materials

Item	Description	Material	Qty
1	10 L FlexGro® Biocontainer	TepoFlex®	1
2	High Flow Check Valve, 3/8" Hose Barb (High Flow Check Valve, 9.5 mm Hose Barb)	Acrylic/Silicone	1
3	3/16" x 3/8" Tubing, 2" Length (4.8 mm x 9.5 mm Tubing, 5.1 cm Length)	Platinum-Cured Silicone	5
4	High Flow Vent Filter	Acrylic/Pallflex	2
5	Slide Clamp, Medium	HDPE	3
6	Male Luer Cap	Polycarbonate	1
7	Swabable Valve / Needleless Injection Site	Polycarbonate/ Silicone	1
8	1/4" Hose Barb x Female Luer Adapter (6.4 mm Hose Barb x Female Luer Adapter)	Polypropylene	1
9	1/4" x 1/8" Hose Barb Reduction Fitting (6.4 mm x 3.2 mm Hose Barb Reduction Fitting)	Polypropylene	1
10	Ratchet Pinch Clamp, Small	Polypropylene	1
11	1/8" x 1/4" Tubing, 40" Length (3.2 mm x 6.4 mm Tubing, 101.6 cm Length)	374 C-Flex	1
12	1/8" Hose Barb x Female Luer Adapter (3.2 mm Hose Barb x Female Luer Adapter)	Polypropylene	1
13	Male Luer Plug	Polypropylene	1
14	Protective Cover, Small	Vinyl	1
15	Ratchet Pinch Clamp, Medium	Polypropylene	1
16	1/4" x 7/16" Tubing, 40" Length (6.4 mm x 11.1 mm Tubing, 101.6 cm Length)	374 C-Flex	1
17	Coupling Body, 1/4" Hose Barb, MPC (Coupling Body, 6.4 mm Hose Barb, MPC)	Polycarbonate	1
18	Sealing Plug, MPC	Polycarbonate	1

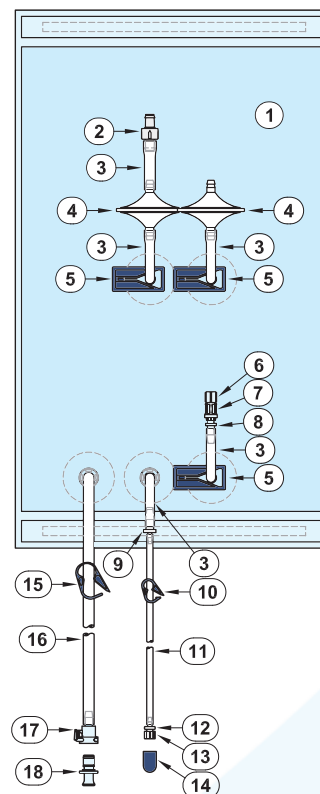

Assembly Part Number	Description	Min Operating Volume	Max Operating Volume
DRA5305B-N04-B0254-01	10 L Expanded Basic FlexGro® Assembly	0.5 L	5 L



Standard Assembly Option

Bill of Materials

Item	Description	Material	Qty
1	10 L FlexGro® Biocontainer	TepoFlex®	1
2	High Flow Check Valve, 3/8" Hose Barb (High Flow Check Valve, 9.5 mm Hose Barb)	Acrylic/Silicone	1
3	3/16" x 3/8" Tubing, 2" Length (4.8 mm x 9.5 mm Tubing, 5.1 cm Length)	Platinum-Cured Silicone	6
4	High Flow Vent Filter	Acrylic/Pallflex	2
5	Slide Clamp, Medium	HDPE	4
6	Protective Cover, Small	Vinyl	2
7	Male Luer Plug	Polypropylene	2
8	1/4" Hose Barb x Female Luer Adapter (6.4 mm Hose Barb x Female Luer Adapter)	Polypropylene	2
9	Male Luer Cap	Polycarbonate	1
10	Swabable Valve / Needleless Injection Site	Polycarbonate/ Silicone	1
11	1/4" x 1/8" Hose Barb Reduction Fitting (6.4 mm x 3.2 mm Hose Barb Reduction Fitting)	Polypropylene	1
12	Ratchet Pinch Clamp, Small	Polypropylene	1
13	1/8" x 1/4" Tubing, 40" Length (3.2 mm x 6.4 mm Tubing, 101.6 cm Length)	374 C-Flex	1
14	1/8" Hose Barb x Female Luer Adapter (3.2 mm Hose Barb x Female Luer Adapter)	Polypropylene	1
15	Ratchet Pinch Clamp, Medium	Polypropylene	1
16	1/4" x 7/16" Tubing, 40" Length (6.4 mm x 11.1 mm Tubing, 101.6 cm Length)	374 C-Flex	1
17	Coupling Body, 1/4" Hose Barb, MPC (Coupling Body, 6.4 mm Hose Barb, MPC)	Polycarbonate	1
18	Sealing Plug, MPC	Polycarbonate	1

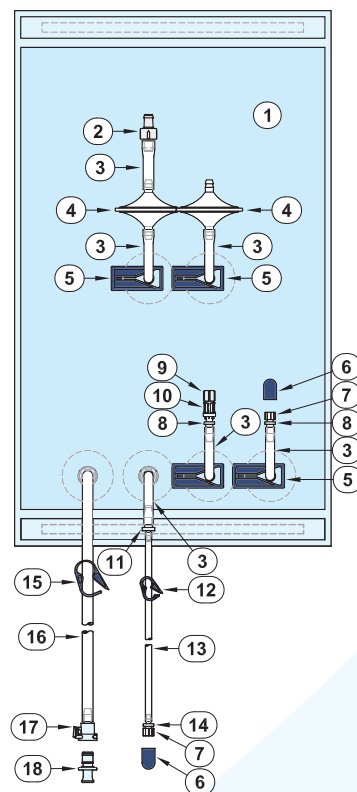

Assembly Part Number	Description	Min Operating Volume	Max Operating Volume
DRA6305B-N02-B0254-01	10 L Standard FlexGro® Assembly	0.5 L	5 L



Basic Assembly Option

Bill of Materials

Item	Description	Material	Qty
1	20 L FlexGro® Biocontainer	TepoFlex®	1
2	High Flow Check Valve, 3/8" Hose Barb (High Flow Check Valve, 9.5 mm Hose Barb)	Acrylic/Silicone	1
3	3/16" x 3/8" Tubing, 2" Length (4.8 mm x 9.5 mm Tubing, 5.1 cm Length)	Platinum-Cured Silicone	4
4	High Flow Vent Filter	Acrylic/Pallflex	2
5	Slide Clamp, Medium	HDPE	3
6	Male Luer Cap	Polycarbonate	1
7	Swabable Valve / Needleless Injection Site	Polycarbonate/ Silicone	1
8	1/4" Hose Barb x Female Luer Adapter (6.4 mm Hose Barb x Female Luer Adapter)	Polypropylene	1
9	Ratchet Pinch Clamp, Medium	Polypropylene	1
10	1/4" x 7/16" Tubing, 40" Length (6.4 mm x 11.1 mm Tubing, 101.6 cm Length)	374 C-Flex	1
11	Coupling Body, 1/4" Hose Barb, MPC (Coupling Body, 6.4 mm Hose Barb, MPC)	Polycarbonate	1
12	Sealing Plug, MPC	Polycarbonate	1

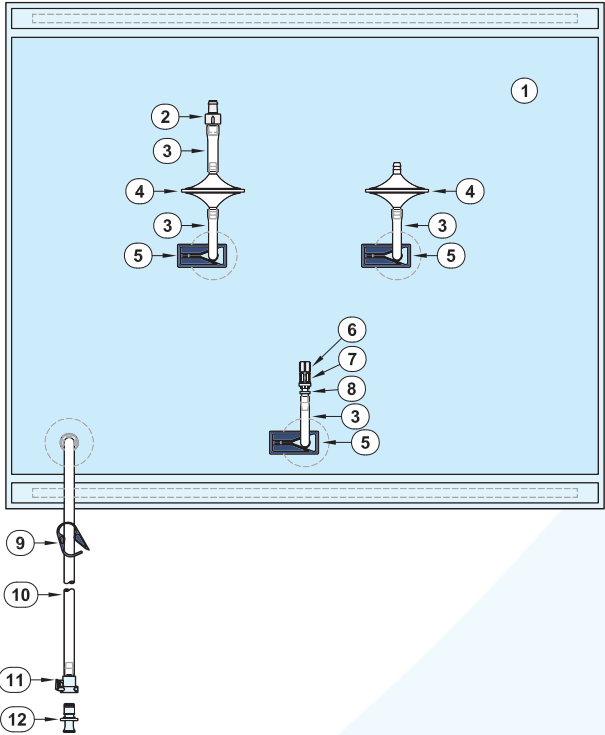

Assembly Part Number	Description	Min Operating Volume	Max Operating Volume
DRA4306B-N01-B0254-01	20 L Basic FlexGro® Assembly	1L	10 L



Expanded Basic Assembly Option

Bill of Materials

Item	Description	Material	Qty
1	20 L FlexGro® Biocontainer	TepoFlex®	1
2	High Flow Check Valve, 3/8" Hose Barb (High Flow Check Valve, 9.5 mm Hose Barb)	Acrylic/Silicone	1
3	3/16" x 3/8" Tubing, 2" Length (4.8 mm x 9.5 mm Tubing, 5.1 cm Length)	Platinum-Cured Silicone	5
4	High Flow Vent Filter	Acrylic/Pallflex	2
5	Slide Clamp, Medium	HDPE	3
6	Male Luer Cap	Polycarbonate	1
7	Swabable Valve / Needleless Injection Site	Polycarbonate/ Silicone	1
8	1/4" Hose Barb x Female Luer Adapter (6.4 mm Hose Barb x Female Luer Adapter)	Polypropylene	1
9	1/4" x 1/8" Hose Barb Reduction Fitting (6.4 mm x 3.2 mm Hose Barb Reduction Fitting)	Polypropylene	1
10	Ratchet Pinch Clamp, Small	Polypropylene	1
11	1/8" x 1/4" Tubing, 40" Length (3.2 mm x 6.4 mm Tubing, 101.6 cm Length)	374 C-Flex	1
12	1/8" Hose Barb x Female Luer Adapter (3.2 mm HB x Female Luer Adapter)	Polypropylene	1
13	Male Luer Plug	Polypropylene	1
14	Protective Cover, Small	Vinyl	1
15	Ratchet Pinch Clamp, Medium	Polypropylene	1
16	1/4" x 7/16" Tubing, 40" Length (6.4 mm x 11.1 mm Tubing, 101.6 cm Length)	374 C-Flex	1
17	Coupling Body, 1/4" Hose Barb, MPC (Coupling Body, 6.4 mm Hose Barb, MPC)	Polycarbonate	1
18	Sealing Plug, MPC	Polycarbonate	1

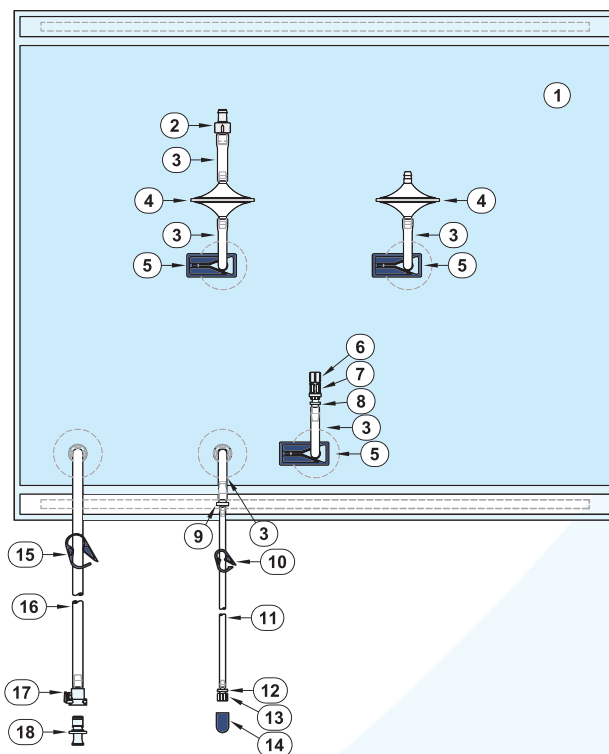

Assembly Part Number	Description	Min Operating Volume	Max Operating Volume
DRA5306B-N07-B0254-01	20 L Expanded Basic FlexGro® Assembly	1L	10 L



Standard Assembly Option

Bill of Materials

Item	Description	Material	Qty
1	20 L FlexGro® Biocontainer	TepoFlex®	1
2	High Flow Check Valve, 3/8" Hose Barb (High Flow Check Valve, 9.5 mm Hose Barb)	Acrylic/Silicone	1
3	3/16" x 3/8" Tubing, 2" Length (4.8 mm x 9.5 mm Tubing, 5.1 cm Length)	Platinum-Cured Silicone	6
4	High Flow Vent Filter	Acrylic/Pallflex	2
5	Slide Clamp, Medium	HDPE	4
6	Protective Cover, Small	Vinyl	2
7	Male Luer Plug	Polypropylene	2
8	1/4" Hose Barb x Female Luer Adapter (6.4 mm Hose Barb x Female Luer Adapter)	Polypropylene	2
9	Male Luer Cap	Polycarbonate	1
10	Swabable Valve / Needleless Injection Site	Polycarbonate/Silicone	1
11	1/4" x 1/8" Hose Barb Reduction Fitting (6.4 mm x 3.2 mm Hose Barb Reduction Fitting)	Polypropylene	1
12	Ratchet Pinch Clamp, Small	Polypropylene	1
13	1/8" x 1/4" Tubing, 40" Length (3.2 mm x 6.4 mm Tubing, 101.6 cm Length)	374 C-Flex	1
14	1/8" Hose Barb x Female Luer Adapter (3.2 mm Hose Barb x Female Luer Adapter)	Polypropylene	1
15	Ratchet Pinch Clamp, Medium	Polypropylene	1
16	1/4" x 7/16" Tubing, 40" Length (6.4 mm x 11.1 mm Tubing, 101.6 cm Length)	374 C-Flex	1
17	Coupling Body, 1/4" Hose Barb, MPC (Coupling Body, 6.4 mm Hose Barb, MPC)	Polycarbonate	1
18	Sealing Plug, MPC	Polycarbonate	1

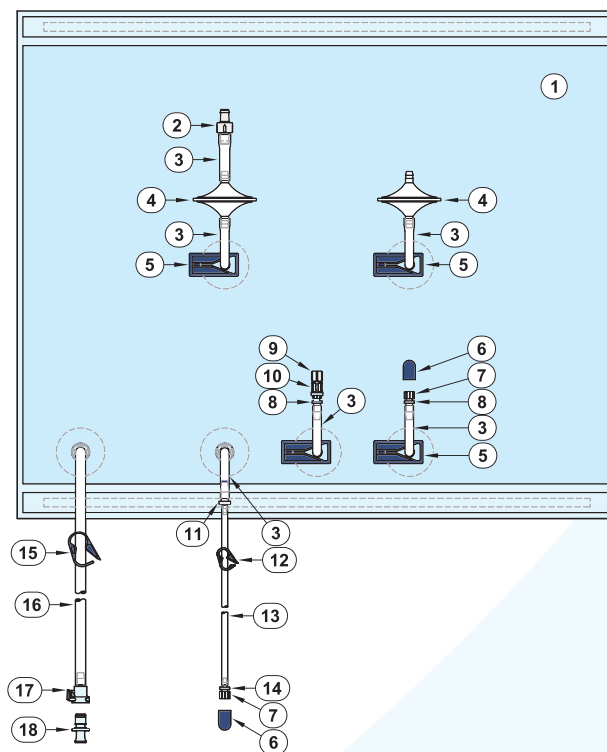

Assembly Part Number	Description	Min Operating Volume	Max Operating Volume
DRA6306B-N02-B0254-01	20 L Standard FlexGro® Assembly	1L	10 L

22
Liter

Basic Assembly Option

Bill of Materials

Item	Description	Material	Qty
1	22 L FlexGro® Biocontainer	TepoFlex®	1
2	High Flow Check Valve, 3/8" Hose Barb High Flow Check Valve, 9.5 mm Hose Barb	Acrylic/Silicone	1
3	3/16" x 3/8" Tubing, 2" Length (4.8 mm x 9.5 mm Tubing, 5.1 cm) Length	Platinum-Cured Silicone	4
4	High Flow Vent Filter	Acrylic/Pallflex	2
5	Slide Clamp, Medium	HDPE	3
6	Male Luer Cap	Polycarbonate	1
7	Swabable Valve / Needleless Injection Site	Polycarbonate/ Silicone	1
8	1/4" Hose Barb x Female Luer Adapter (6.4 mm Hose Barb x Female Luer Adapter)	Polypropylene	1
9	Ratchet Pinch Clamp, Medium	Polypropylene	1
10	1/4" x 7/16" Tubing, 40" Length (6.4 mm x 11.1 mm Tubing, 101.6 cm) Length	374 C-Flex	1
11	Coupling Body, 1/4" Hose Barb, MPC Coupling Body, 6.4 mm Hose Barb, MPC	Polycarbonate	1
12	Sealing Plug, MPC	Polycarbonate	1

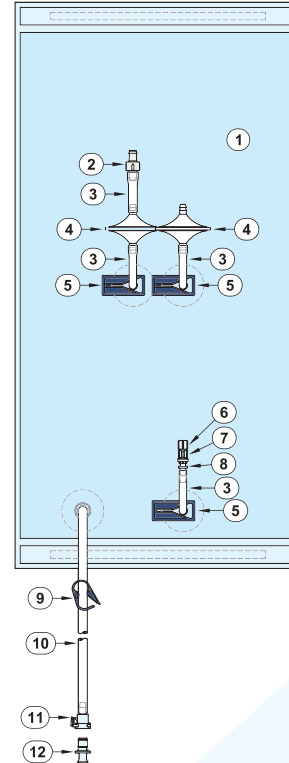

Assembly Part Number	Description	Min Operating Volume	Max Operating Volume
DRA4306B-N04-B0254-01	22 L Basic FlexGro® Assembly	1L	10 L

22
Liter

Expanded Basic Assembly Option

Bill of Materials

Item	Description	Material	Qty
1	20 L FlexGro® Biocontainer	TepoFlex®	1
2	High Flow Check Valve, 3/8" Hose Barb (High Flow Check Valve, 9.5 mm Hose Barb)	Acrylic/Silicone	1
3	3/16" x 3/8" Tubing, 2" Length (4.8 mm x 9.5 mm Tubing, 5.1 cm Length)	Platinum-Cured Silicone	5
4	High Flow Vent Filter	Acrylic/Pallflex	2
5	Slide Clamp, Medium	HDPE	3
6	Male Luer Cap	Polycarbonate	1
7	Swabable Valve / Needleless Injection Site	Polycarbonate/ Silicone	1
8	1/4" Hose Barb x Female Luer Adapter (6.4 mm Hose Barb x Female Luer Adapter)	Polypropylene	1
9	1/4" x 1/8" Hose Barb Reduction Fitting (6.4 mm x 3.2 mm Hose Barb Reduction Fitting)	Polypropylene	1
10	Ratchet Pinch Clamp, Small	Polypropylene	1
11	1/8" x 1/4" Tubing, 40" Length (3.2 mm x 6.4 mm Tubing, 101.6 cm Length)	374 C-Flex	1
12	1/8" Hose Barb x Female Luer Adapter (3.2 mm Hose Barb x Female Luer Adapter)	Polypropylene	1
13	Male Luer Plug	Polypropylene	1
14	Protective Cover, Small	Vinyl	1
15	Ratchet Pinch Clamp, Medium	Polypropylene	1
16	1/4" x 7/16" Tubing, 40" Length (6.4 mm x 11.1 mm Tubing, 101.6 cm Length)	374 C-Flex	1
17	Coupling Body, 1/4" Hose Barb, MPC (Coupling Body, 6.4 mm Hose Barb, MPC)	Polycarbonate	1
18	Sealing Plug, MPC	Polycarbonate	1

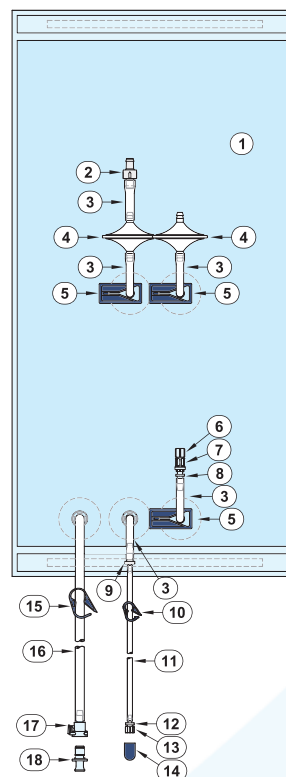

Assembly Part Number	Description	Min Operating Volume	Max Operating Volume
DRA5306B-N08-B0254-01	22 L Expanded Basic FlexGro® Assembly	1L	10 L



Standard Assembly Option

Bill of Materials

Item	Description	Material	Qty
1	22 L FlexGro® Biocontainer	TepoFlex®	1
2	High Flow Check Valve, 3/8" Hose Barb (High Flow Check Valve, 9.5 mm Hose Barb)	Acrylic/Silicone	1
3	3/16" x 3/8" Tubing, 2" Length (4.8 mm x 9.5 mm Tubing, 5.1 cm Length)	Platinum-Cured Silicone	6
4	High Flow Vent Filter	Acrylic/Pallflex	2
5	Slide Clamp, Medium	HDPE	4
6	Protective Cover, Small	Vinyl	2
7	Male Luer Plug	Polypropylene	2
8	1/4" Hose Barb x Female Luer Adapter (6.4 mm Hose Barb x Female Luer Adapter)	Polypropylene	2
9	Male Luer Cap	Polycarbonate	1
10	Swabable Valve / Needleless Injection Site	Polycarbonate/ Silicone	1
11	1/4" x 1/8" Hose Barb Reduction Fitting (6.4 mm x 3.2 mm Hose Barb Reduction Fitting)	Polypropylene	1
12	Ratchet Pinch Clamp, Small	Polypropylene	1
13	1/8" x 1/4" Tubing, 40" Length (3.2 mm x 6.4 mm Tubing, 101.6 cm Length)	374 C-Flex	1
14	1/8" Hose Barb x Female Luer Adapter (3.2 mm Hose Barb x Female Luer Adapter)	Polypropylene	1
15	Ratchet Pinch Clamp, Medium	Polypropylene	1
16	1/4" x 7/16" Tubing, 40" Length (6.4 mm x 11.1 mm Tubing, 101.6 cm Length)	374 C-Flex	1
17	Coupling Body, 1/4" Hose Barb, MPC Coupling Body, 6.4 mm Hose Barb, MPC	Polycarbonate	1
18	Sealing Plug, MPC	Polycarbonate	1

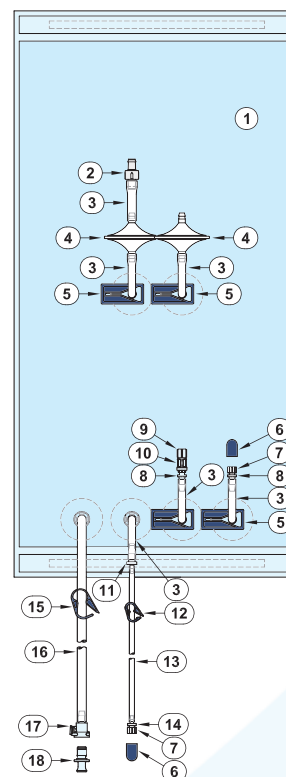

Assembly Part Number	Description	Min Operating Volume	Max Operating Volume
DRA6306B-N05-B0254-01	22 L Standard FlexGro® Assembly	1L	10 L



Basic Assembly Option

Bill of Materials

Item	Description	Material	Qty
1	50 L FlexGro® Biocontainer	TepoFlex®	1
2	High Flow Check Valve, 3/8" Hose Barb (High Flow Check Valve, 9.5 mm Hose Barb)	Acrylic/Silicone	1
3	3/16" x 3/8" Tubing, 2" Length (4.8 mm x 9.5 mm Tubing, 5.1 cm Length)	Platinum-Cured Silicone	4
4	High Flow Vent Filter	Acrylic/Pallflex	2
5	Slide Clamp, Medium	HDPE	3
6	Male Luer Cap	Polycarbonate	1
7	Swabable Valve / Needleless Injection Site	Polycarbonate/ Silicone	1
8	1/4" Hose Barb x Female Luer Adapter (6.4 mm Hose Barb x Female Luer Adapter)	Polypropylene	1
9	Ratchet Pinch Clamp, Medium	Polypropylene	1
10	1/4" x 7/16" Tubing, 40" Length (6.4 mm x 11.1 mm Tubing, 101.6 cm Length)	374 C-Flex	1
11	Coupling Body, 1/4" Hose Barb, MPC (Coupling Body, 6.4 mm Hose Barb, MPC)	Polycarbonate	1
12	Sealing Plug, MPC	Polycarbonate	1

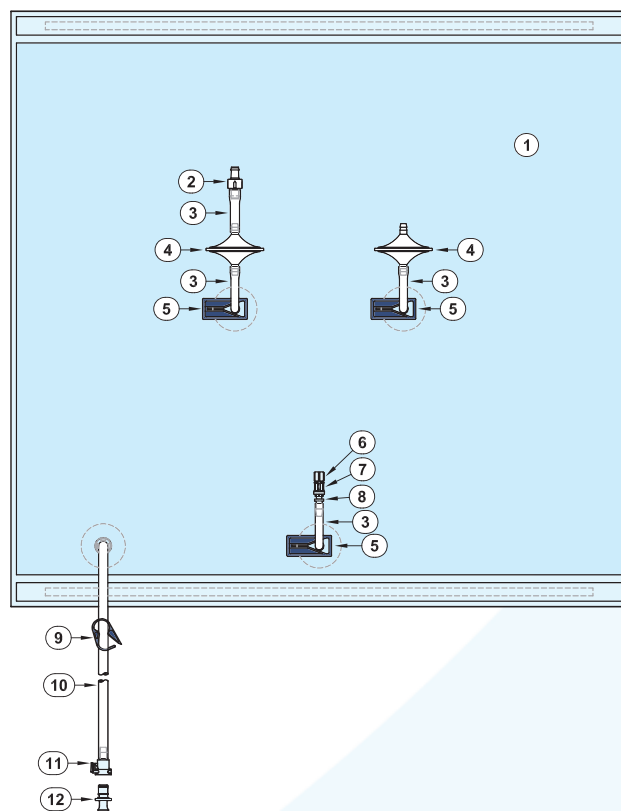

Assembly Part Number	Description	Min Operating Volume	Max Operating Volume
DRA4307B-N01-B0254-01	50 L Basic FlexGro® Assembly	5 L	25 L



Expanded Basic Assembly Option

Bill of Materials

Item	Description	Material	Qty
1	50 L FlexGro® Biocontainer	TepoFlex®	1
2	High Flow Check Valve, 3/8" Hose Barb (High Flow Check Valve, 9.5 mm Hose Barb)	Acrylic/Silicone	1
3	3/16" x 3/8" Tubing, 2" Length (4.8 mm x 9.5 mm Tubing, 5.1 cm Length)	Platinum-Cured Silicone	5
4	High Flow Vent Filter	Acrylic/Pallflex	2
5	Slide Clamp, Medium	HDPE	3
6	Male Luer Cap	Polycarbonate	1
7	Swabable Valve / Needleless Injection Site	Polycarbonate/Silicone	1
8	1/4" Hose Barb x Female Luer Adapter (6.4 mm Hose Barb x Female Luer Adapter)	Polypropylene	1
9	1/4" x 1/8" Hose Barb Reduction Fitting (6.4 mm x 3.2 mm Hose Barb Reduction Fitting)	Polypropylene	1
10	Ratchet Pinch Clamp, Small	Polypropylene	1
11	1/8" x 1/4" Tubing, 40" Length (3.2 mm x 6.4 mm Tubing, 101.6 cm Length)	374 C-Flex	1
12	1/8" Hose Barb x Female Luer Adapter (3.2 mm Hose Barb x Female Luer Adapter)	Polypropylene	1
13	Male Luer Plug	Polypropylene	1
14	Protective Cover, Small	Vinyl	1
15	Ratchet Pinch Clamp, Medium	Polypropylene	1
16	1/4" x 7/16" Tubing, 40" Length (6.4 mm x 11.1 mm Tubing, 101.6 cm Length)	374 C-Flex	1
17	Coupling Body, 1/4" Hose Barb, MPC (Coupling Body, 6.4 mm Hose Barb, MPC)	Polycarbonate	1
18	Sealing Plug, MPC	Polycarbonate	1

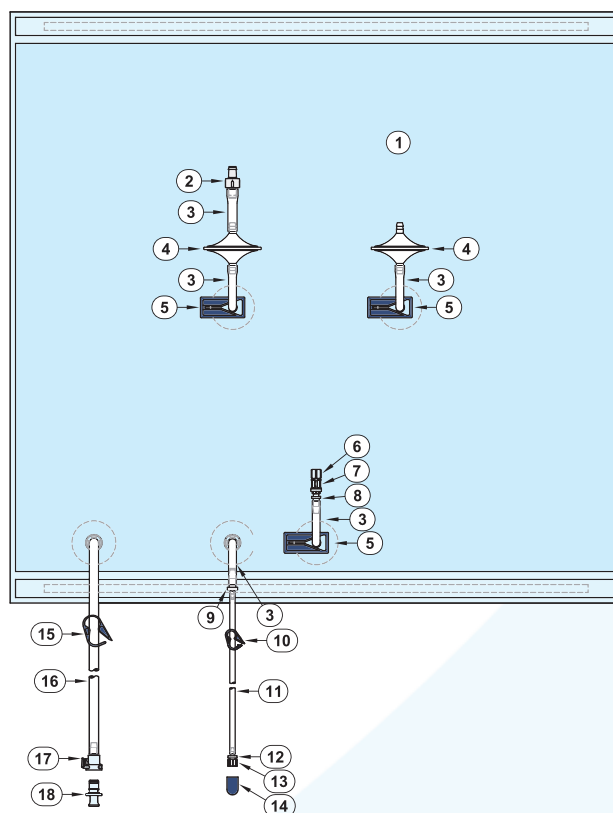

Assembly Part Number	Description	Min Operating Volume	Max Operating Volume
DRA5307B-N04-B0254-01	50 L Expanded Basic FlexGro® Assembly	5 L	25 L



Standard Assembly Option

Bill of Materials

Item	Description	Material	Qty
1	50 L FlexGro® Biocontainer	TepoFlex®	1
2	High Flow Check Valve, 3/8" Hose Barb (High Flow Check Valve, 9.5 mm Hose Barb)	Acrylic/Silicone	1
3	3/16" x 3/8" Tubing, 2" Length (4.8 mm x 9.5 mm Tubing, 5.1 cm Length)	Platinum-Cured Silicone	6
4	High Flow Vent Filter	Acrylic/Pallflex	2
5	Slide Clamp, Medium	HDPE	4
6	Protective Cover, Small	Vinyl	2
7	Male Luer Plug	Polypropylene	2
8	1/4" Hose Barb x Female Luer Adapter (6.4 mm Hose Barb x Female Luer Adapter)	Polypropylene	2
9	Male Luer Cap	Polycarbonate	1
10	Swabable Valve / Needleless Injection Site	Polycarbonate/ Silicone	1
11	1/4" x 1/8" Hose Barb Reduction Fitting (6.4 mm x 3.2 mm Hose Barb Reduction Fitting)	Polypropylene	1
12	Ratchet Pinch Clamp, Small	Polypropylene	1
13	1/8" x 1/4" Tubing, 40" Length (3.2 mm x 6.4 mm Tubing, 101.6 cm Length)	374 C-Flex	1
14	1/8" Hose Barb x Female Luer Adapter (3.2 mm Hose Barb x Female Luer Adapter)	Polypropylene	1
15	Ratchet Pinch Clamp, Medium	Polypropylene	1
16	1/4" x 7/16" Tubing, 40" Length (6.4 mm x 11.1 mm Tubing, 101.6 cm Length)	374 C-Flex	1
17	Coupling Body, 1/4" Hose Barb, MPC Coupling Body, 6.4 mm Hose Barb, MPC	Polycarbonate	1
18	Sealing Plug, MPC	Polycarbonate	1

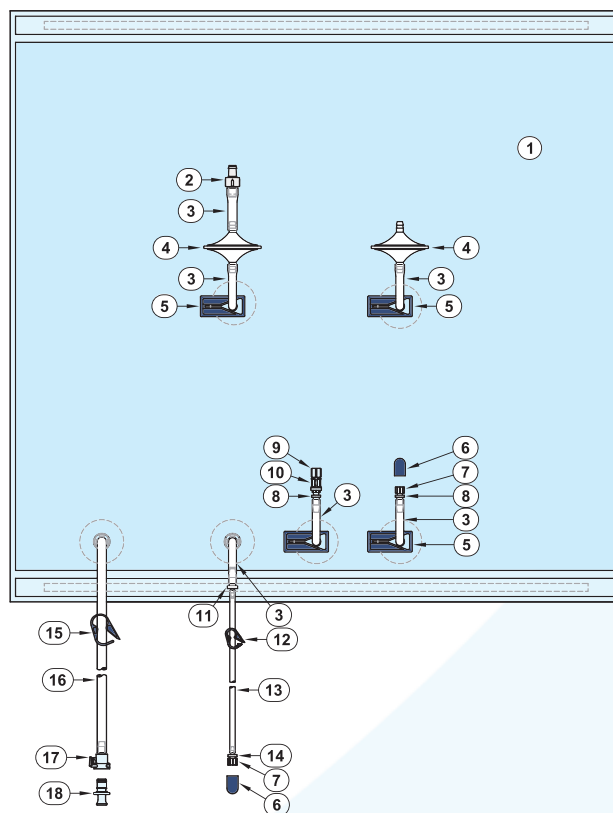

Assembly Part Number	Description	Min Operating Volume	Max Operating Volume
DRA6307B-N02-B0254-01	50 L Standard FlexGro® Assembly	5 L	25 L



FlexGro®, FlexFill®, TepoFlex® and One-Touch® are registered trademarks of Meissner Filtration Products, Inc.
Pallflex® is a registered trademark of Pall Corporation.
© 2015 Meissner Filtration Products, Inc. All Rights Reserved.
FG 1.0

 **MEISSNER**
FILTRATION PRODUCTS

1001 Flynn Road • Camarillo, CA 93012 • USA
+1.805.388.9911 • +1.805.388.5948 Fax
www.meissner.com